

Glassen Monarch Raingarden

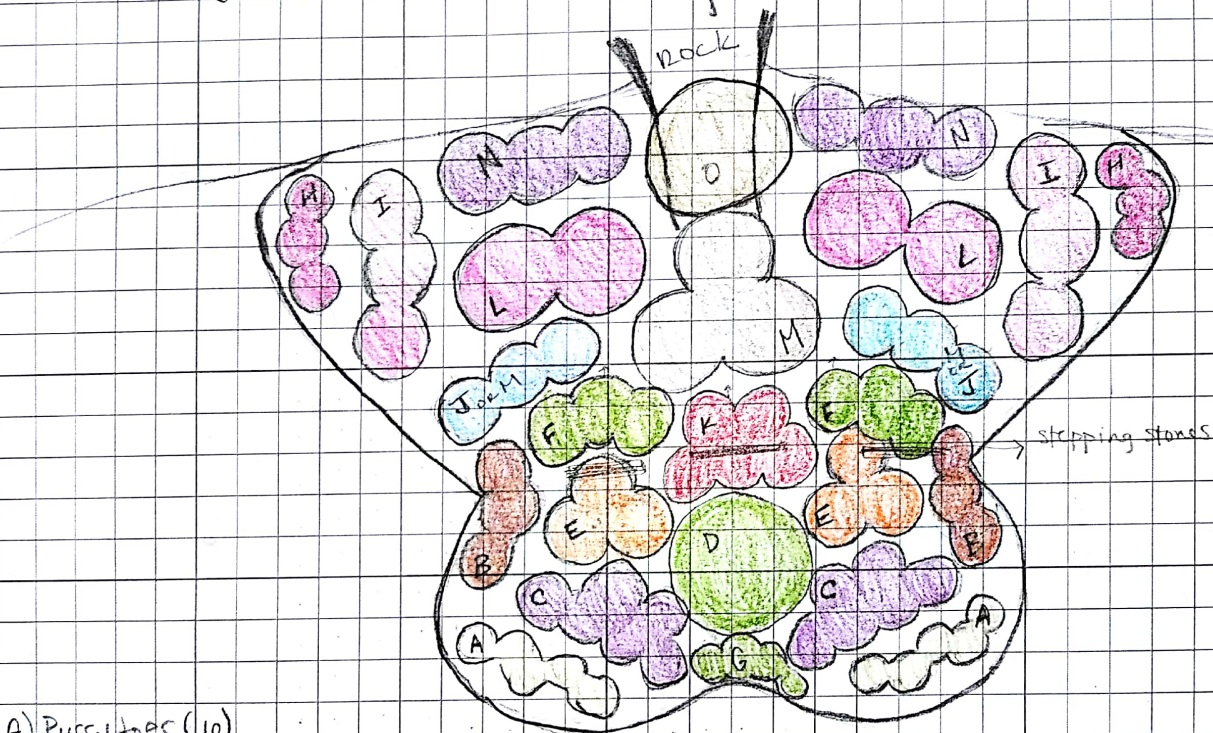

A) Pussy toes (10)

B) Coral bells (6-3)

C) Purple clover flower (10)

D) Black chokeberry or (1)

↳ Snowberry (white) or

↳ New Jersey Tea

E) Butterfly milkweed (6-

F) Turtlehead (white) (6)

G) Wild Strawberry (3)

H) Poppy mallow (6) or

↳ wild geranium

I) Penstemon (6)

J) Great blue lobelia (6)

K) Cardinal flower (5)

L) Ironweed (4)

M) Swamp milkweed (3)

N) Liatris-meadow (6)

O) Baptisia wild white (1)
Indigo



Raingarden Project Worksheet Cost Estimate



Landowner: Jason & Robin Glassen
 Street Address: 1437 Valley Dr.
 City, Zip: Burnsville, MN 55337

Water Conveyance (if needed)	Qty	Unit	Unit Cost	Amount
Downspout connector				—
Drain Tile or PVC Piping				—
Critter Guard				—
Pop Up Emitter				—
River Rock Splash Area (at outlet of drain-tile pipe)	5	.5 cubic foot	\$ 5	\$ 25
WATER CONVEYANCE COSTS				\$ 25

Grading and Site Prep Related Materials	Qty	Unit	Unit Cost	Amount
Sod Cutter	1	hr	\$ 50	\$ 50
Rototiller		hr	\$ 20	\$ 20
Leaf-Compost/Soil Replacement for Raingarden (well-aged, weed-seed free)	1.5	cu yd	\$ 25	\$ 37.50
Delievery (Leaf-Compost)		delivery	\$	\$
Edging (Type Rubber (two types))	45	ft	\$ 3.67	\$ 165.15
Edging Trencher	1	hr	\$ 50	\$ 50
GRADING AND SITE-PREPARATION RELATED COSTS				\$ 382.65

Mulch	Qty	Unit	Unit Cost	Amount
Shredded Hardwood Mulch (2-3" depth) (entire planting area) (1 cy = 150 sq. ft.)	1.5	cu yd	\$ 50	\$ 75
Delivery (Wood Mulch)		load	\$	\$ —
MULCH AND DELIVERY COSTS				\$ 75

Plant Materials (Plugs & Plots)	Qty	Unit	Unit Cost	Amount
Native Perennial Plugs (12" spacing)		each	\$	\$
Native Perennial 3-4" Pots (12" spacing)	27		\$ 5	\$ 135
Cultivar Perennials (" spacing)				
Other Plants (larger container size)	48	each	\$ 10	\$ 480
Native Shrubs (for Soils) (36" spacing)	1	each	\$ 30	\$ 30
Delivery (Plants)		delivery	\$	\$ —
PLANT MATERIAL COSTS				\$ 645

OTHER COSTS (retaining wall, excavation equipment, erosion control blanket, etc.) \$

Total Project Cost \$ 1,127.65

1. APPLICANT/CONTACT

Name: Robin Gauigher Glassen
 Address: 1437 Valley Dr
 City, State Zip: Burnsville, MN 55337
 Phone: 952.942.6882 / 612.532.4764
 Email: RRB37@aol.com

2. PROJECT TYPE: Raingarden Native Garden Shoreline
 3. SOURCE OF RUNOFF: Roof Driveway Other (Specify) _____
 4. SIZE OF RUNOFF AREA: 575 square feet
 5. SIZE OF RAINGARDEN / NATIVE GARDEN / SHORELINE: 200 square feet
 6. Public Outreach: Are you willing to allow a small sign to be placed near the project and site visits?
 Yes No
 7. Which application round would you like to apply for?

	Application Deadline	Project Completion Deadline*
<input checked="" type="checkbox"/> Round 1May 1 st , 2018.....	July 16 th , 2018
<input type="checkbox"/> Round 2May 31 st , 2018.....	August 20 th , 2018
<input type="checkbox"/> Round 3July 23 rd , 2018.....	November 1 st , 2018

* Grant automatically expires if the project is not completed by the deadline.

8. ITEMS TO SUBMIT:	1. Grant Application Form	2. Cost Estimate
	3. Map with Project Location	4. Planting Plan

I certify that to the best of my knowledge and belief that the information contained in this application is true, complete and accurate:

Robin Gauigher Glassen 5.1.18
 Signature of Applicant/Contact Date
Robin Gauigher Glassen 5.1.18
 Signature of Property Owner(s) Date

Landscaping for Clean Water Grant Policy

- Eligible project types are limited to native gardens, raingardens and native shoreline stabilizations that demonstrate compliance with Landscaping for Clean Water technical recommendations.
- Grant applicants must successfully complete a Landscaping for Clean Water design workshop and submit a grant application, project plan, and cost estimate for District review and approval prior to beginning the installation. (grant is not retroactive)
- District staff will review applications, select grant recipients, verify completed projects, and distribute grants in accordance to program policy.
- Applications requesting grant approval will be reviewed in three application rounds. Application must be received by a round's start date and awarded grants automatically expire if the project is not completed by the end date of the round it was awarded in. Those dates are shown above.
- Expired grants and grants not awarded (if any) will be made available to subsequent application rounds or the remaining funds may be reallocated to other cost share programs per the approved work plan. The number of grants awarded shall be limited by the amount of funding available and the amount of District staff time available to provide technical assistance. (application window may be extended at District staff discretion).
- The Landscaping for Clean Water grant amount is limited to \$250.00 per approved application. Only one grant allowed per applicant per year. Applications not approved in a preceding round may be resubmitted for review in following rounds.
- District Staff will prioritize grant awards based on watershed location, proximity to water resources, and potential to provide water quality benefits.

Landscaping for Clean Water Grants Process

- Attend Landscaping for Clean Water workshop series and develop site-specific project plans.
- Submit application, project plans, and cost estimate by the above application deadline for approval prior to beginning installation.
- Schedule an on-site meeting with Dakota County SWCD prior to beginning installation. Call Gopher State One Call (800-252-1166) to have utilities located before the on-site meeting.
- Install project and then contact Dakota County SWCD to verify completed project.
- Receive \$250 Landscaping for Clean Water Grant from Dakota County SWCD.
- Grant will automatically expire if the project is not completed by the completion deadline for the round in which the grant was approved.



- Legend**
- 10 ft Contour
 - 1 ft Contour
 - Buildings
 - 50 Lot Dimensions
 - Tax Parcels

GLASSEN WILLIAM J
 ROBIN GALLIGHER GLASSEN
 1437 VALLEY DR
 BURNSVILLE, MN 55337
 LOWER MINNESOTA RIVER
 PIN#: 037-028220302020

BURNSVILLE
 -93.298915 44.770623

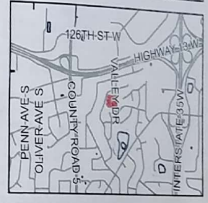
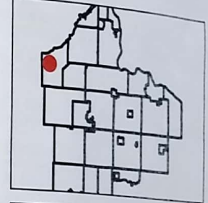

DAKOTA COUNTY
 SOIL & WATER
 CONSERVATION DISTRICT

This drawing is neither a legal nor a title document and is not intended to be used as such. It is provided as a service to the public. The drawing is a compilation of various information and data sources including GPS, County and State Office and other sources. While the drawing is a compilation of various information and data sources, the County, State and other offices are not responsible for any errors or omissions. The drawing is for informational purposes only. Contact the County Office for more information. Contact the County Office for more information. Contact the County Office for more information.

MAP 1 - AERIAL PHOTO WITH CONTOUR LINES

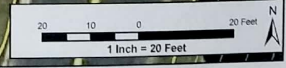

Property Map

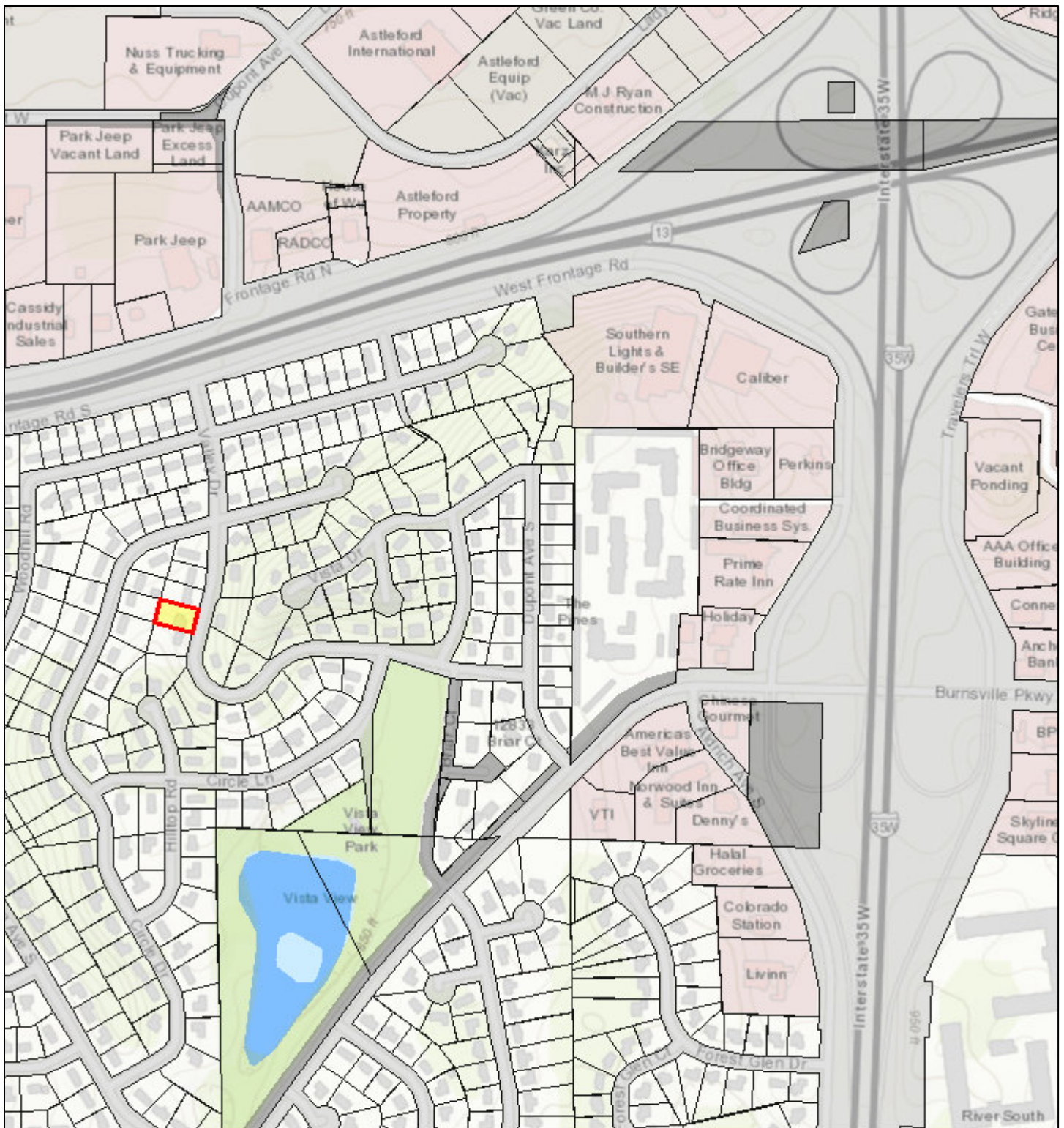

May 11, 2018

1:9,028

Parcels

- Tax Parcel
- Dedicated Right of Way
- Water in Tax Parcel
- Right of Way Easement

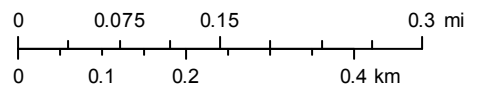

Sources: Esri, HERE, Garmin, Intermap, increment P Corp., GEBCO, USGS, FAO, NPS, NRCAN, GeoBase, IGN, Kadaster NL, Ordnance Survey, Esri Japan, METI, Esri China (Hong Kong), swisstopo, © OpenStreetMap contributors, and the GIS User Community

Property Map



May 11, 2018

Parcels

 Dedicated Right of Way

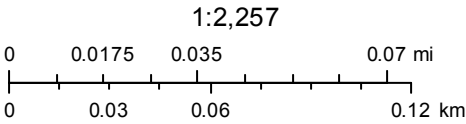

Source: Esri, DigitalGlobe, GeoEye, Earthstar Geographics, CNES/Airbus DS, USDA, USGS, AeroGRID, IGN, and the GIS User Community

