

CADD USER: Jim Stabing FILE: M:\DESIGNS\SURVEY\2310102809\2310102809\_BASE\_SUR\_SURVEY\_2020\_AREA\_3\_SECTIONS.DWG PLOT SCALE: 1:2 PLOT DATE: 9/18/2020 3:43 PM

JHS: M:\Design\Survey\2310102809\2310102809\_BASE\_SUR\_SURVEY\_2020\_AREA\_3\_SECTIONS.dwg Plt at 100 09/18/2020 14:25:21

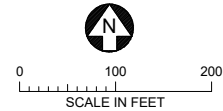
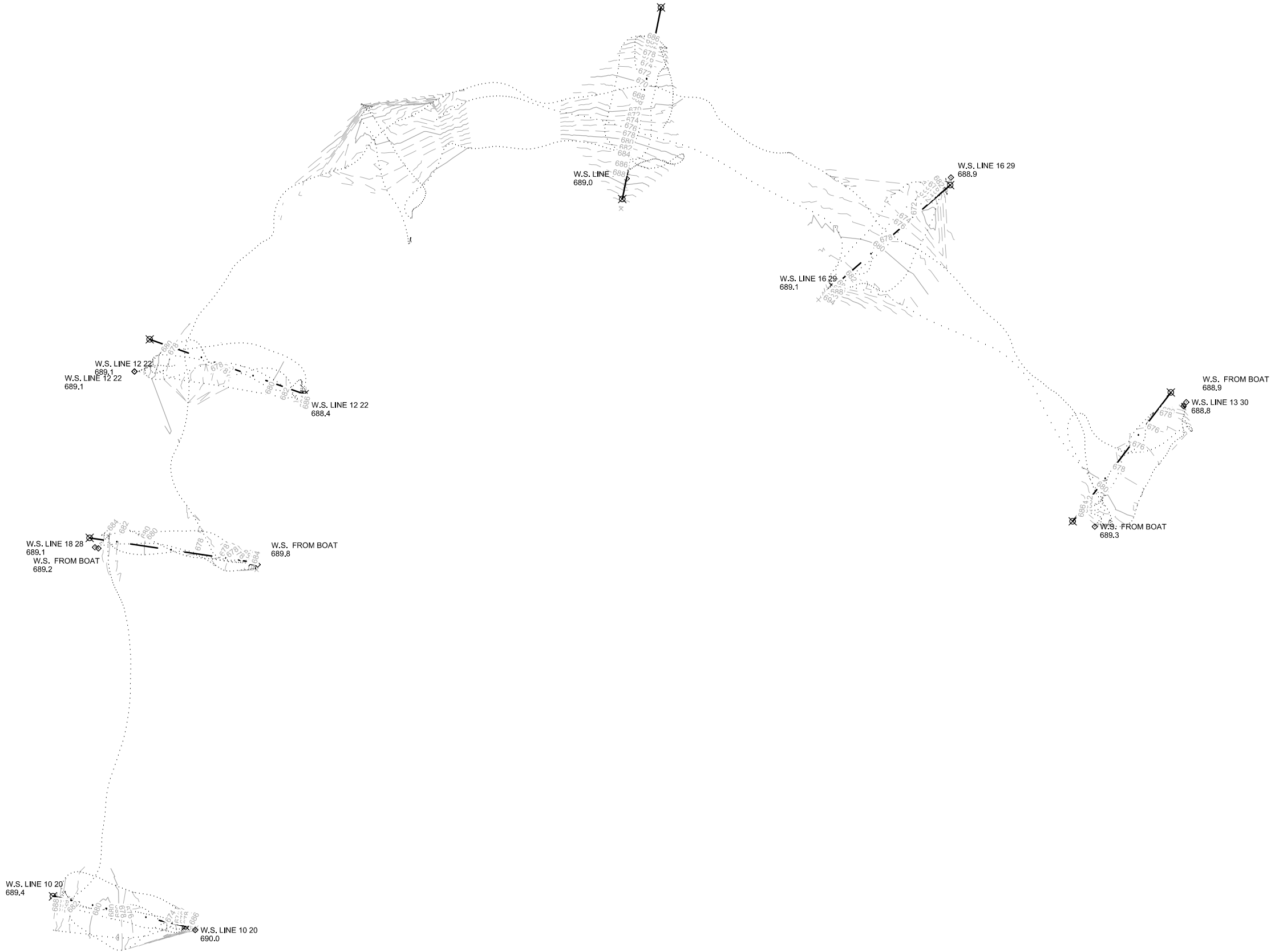

### SURVEY LEGEND

- WATER SURFACE DESIGN POINT
- BATHYMETRIC POINTS
- 800 MAJOR CONTOUR
- 801 MINOR CONTOUR

#### BASIS OF DRAWING FILE:

DATE OF SURVEY: 09-03-2020  
ORIGIN/DATE OF BASE: STATE PLANE/2020  
COORDINATE SYSTEM: Minnesota State Plane, South Zone  
HORIZONTAL DATUM: NAD83(2011) REF. VRS SYSTEM  
VERTICAL DATUM: NAVD88 REF. VRS SYSTEM  
ADDITIONAL FILE INFORMATION:  
HYDROGRAPHIC SYSTEM  
-CEE ECHO HYDROGRAPHIC SURVEY ECHO SOUNDER SYSTEM  
-CEE ECHO 200 KHZ TRANSDUCER  
-RTK GPS

					I HEREBY CERTIFY THAT THIS PLAN, SPECIFICATION, OR REPORT WAS PREPARED BY ME OR UNDER MY DIRECT SUPERVISION AND THAT I AM A DULY LICENSED PROFESSIONAL ENGINEER UNDER THE LAWS OF THE STATE OF MINNESOTA.										<div>Project Office: BARR ENGINEERING CO. 4300 MARKETPOINTE DRIVE Suite 200 MINNEAPOLIS, MN 55435 Corporate Headquarters: Minneapolis, Minnesota Ph: 1-800-632-2277 Fax: (952) 832-2601 www.barr.com</div>					Scale	AS SHOWN	<div>LMRWD EDEN PRIARIE, MINNESOTA</div>					AREA 3 SECTIONS EDEN PRAIRIE, MINNESOTA					BARR PROJECT No. 23/10-1028.09																	
															Date	JHS	CLIENT PROJECT No.																																
															Drawn																																		
															Checked																																		
															Designed																																		
																				Approved		<div>MINNESOTA RIVER BATHYMATHEMETRY 6 SECTIONS</div>					<div>DWG. No.</div> <div>REV. No.</div>																						